

SPRING CLIP WITH EYE

316 STAINLESS STEEL



Import



Wire Formed

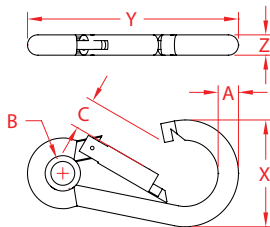

| ITEM | A (size) | B | C | X (height) | Y (length) | Z (width) | WLL (lb) | WT (lb) | PACKAGING TYPE | EACH (qty) | INNER (qty) | CARTON (qty) | UPC |
|------------|----------|-------|-------|------------|------------|-----------|----------|---------|----------------|------------|-------------|--------------|--------------|
| S0121-0050 | 3/16" | 0.25" | 0.25" | 1.03" | 2.00" | 0.19" | 120 | 0.04 | POLYBAG | 1 | 10 | 800 | 791506030997 |
| S0121-0060 | 1/4" | 0.30" | 0.27" | 1.16" | 2.38" | 0.23" | 150 | 0.06 | POLYBAG | 1 | 10 | 500 | 791506031000 |
| S0121-0070 | 9/32" | 0.32" | 0.34" | 1.31" | 2.75" | 0.26" | 200 | 0.09 | POLYBAG | 1 | 10 | 250 | 791506031017 |
| S0121-0080 | 5/16" | 0.40" | 0.38" | 1.57" | 3.13" | 0.30" | 280 | 0.14 | POLYBAG | 1 | 10 | 200 | 791506031024 |
| S0121-0100 | 3/8" | 0.50" | 0.54" | 1.95" | 3.88" | 0.38" | 400 | 0.27 | POLYBAG | 1 | 10 | 100 | 791506031031 |
| S0121-0120 | 7/16" | 0.60" | 0.65" | 2.35" | 4.75" | 0.42" | 500 | 0.41 | POLYBAG | 1 | 1 | 60 | 791506031048 |
| S0121-0140 | 15/32" | 0.80" | 0.80" | 2.62" | 5.50" | 0.46" | 750 | 0.57 | POLYBAG | 1 | 1 | 50 | 791506031055 |
| S0121-0160 | 1/2" | 0.87" | 0.95" | 2.92" | 6.15" | 0.50" | 900 | 0.76 | POLYBAG | 1 | 1 | 40 | 791506031062 |

NOTE:

**EACH CLIP IS STAMPED WITH "316" AND WLL (LB). COMMERCIAL GRADE.
ALL DIMENSIONS ARE NOMINAL (+/- 3%) AND ARE SUBJECT TO CHANGE WITHOUT NOTICE.**